



11 Sourton Square

Saltram Meadow, Plymouth, PL9 7FR

£319,950



Mid-terraced 3-storey townhouse in a nice position overlooking the square & enjoying a westerly-facing rear garden. The accommodation briefly comprises an entrance hall, downstairs cloakroom/wc and a ground floor open-plan living room & kitchen. The first floor comprises 2 double bedrooms, one with an ensuite shower room. The other double bedroom could be used as a first-floor lounge, if required. The top floor has 3 bedrooms & a bathroom. Garage situated to the rear. Double-glazing & central heating.



SOURTON SQUARE, SALTRAM MEADOW, PL9 9FR

ACCOMMODATION

Front door opening into the entrance hall.

ENTRANCE HALL 9'4 x 6'11 at widest point (2.84m x 2.11m at widest point)
Providing access to the accommodation. Storage cupboard. Tiled floor. Staircase ascending to the first floor.

DOWNSTAIRS CLOAKROOM/WC 5'1 x 2'9 (1.55m x 0.84m)
Fitted with a low level flush wc and corner-style basin with a tiled splash-back. Obscured window to the front elevation.

OPEN-PLAN LIVING ROOM/KITCHEN 27'9 x 13'10 at widest point (8.46m x 4.22m at widest point)
A generous open-plan ground floor room which is dual aspect with windows with fitted blinds to the front and rear elevations. French doors to the rear opening onto the west-facing garden. Under-stairs storage cupboard. Tiled floor. Ample space for seating and dining. The kitchen area, which is situated to the rear of the room, has a range of base and wall-mounted cabinets with matching fascias, work surfaces and splash-backs. Inset single drainer sink unit. Built-in oven. Stainless-steel gas hob with a glass splash-back and a cooker hood above. Integral dishwasher. Space for free-standing fridge-freezer. Wall-mounted gas boiler.

FIRST FLOOR LANDING
Providing access to the first floor accommodation. Recessed cupboard. Staircase ascending to the top floor.

BEDROOM ONE 13'8 x 11'2 max dimensions (4.17m x 3.40m max dimensions)
Situated to the front elevation. This room could be used as first-floor lounge if required. French doors to the front opening onto a stainless-steel Juliette balcony. Additional window to the front elevation.

BEDROOM TWO 13'10 x 8'11 (4.22m x 2.72m)
Originally the master bedroom. 2 windows with fitted blinds to the rear elevation. Doorway opening into the ensuite shower room.

ENSUITE SHOWER ROOM 6'11 x 6'3 into shower (2.11m x 1.91m into shower)
Comprising an enclosed double-sized shower with a sliding glass door, pedestal basin and wc. Mirrored medicine cabinet.

TOP FLOOR LANDING
Providing access to the remaining accommodation. Loft hatch. Over-stairs cupboard fitted with a hanging rail and shelving.

BEDROOM THREE 13'10 x 9'2 max dimensions (4.22m x 2.79m max dimensions)
2 windows with fitted blinds to the rear elevation providing nice views towards Plymouth.

BEDROOM FOUR 11'3 x 6'7 (3.43m x 2.01m)
Window with a fitted blind to the front elevation.

DRESSING ROOM/BEDROOM FIVE 8'7 x 6'10 (2.62m x 2.08m)
Window to the front elevation.

FAMILY BATHROOM 6'7 x 6'6 (2.01m x 1.98m)
Comprising a bath with a shower system over and a glass screen, pedestal basin and wc. Wall-mounted mirror. Partly-tiled walls.

GARAGE 18'8 x 9'6 (5.69m x 2.90m)
Situated to the rear of the property. Up-&-over door. Pitched roof.

OUTSIDE
The garden has been landscaped with areas laid to patio, artificial grass and a small decked area. Rear access gate. Outside tap. Outside light.

COUNCIL TAX
Plymouth City Council
Council tax band D

SERVICES
The property is connected to all the mains services: gas, electricity, water and drainage.

Area Map



Floor Plans

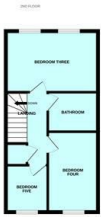
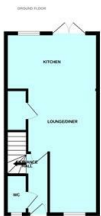

Made with Metapix ©2025

Energy Efficiency Graph

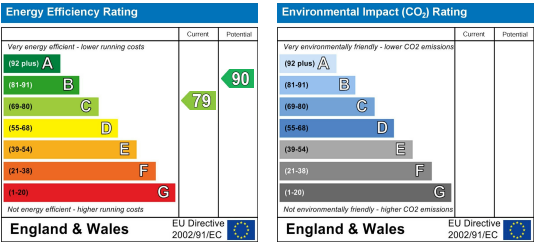

These particulars, whilst believed to be accurate are set out as a general outline only for guidance and do not constitute any part of an offer or contract. Intending purchasers should not rely on them as statements of representation of fact, but must satisfy themselves by inspection or otherwise as to their accuracy. No person in this firms employment has the authority to make or give any representation or warranty in respect of the property.